

PRIMINER

VF Series

Ultra High Performance Center

PRECISE · DYNAMIC · RELIABLE



VF1100

- VF series ultra high performance center is specially designed for high speed and high efficiency machining applications
- Advanced design with reinforced body structure through FEM analysis. VF series offers superb cutting performance and reduced vibration to meet the highest machining demands
- Extra wide machine column and base design ensures the high rigidity during high speed movement
- Motor seat cooling circuit
- Oil cooling through ballscrew (optional)
- Linear scales (optional)

Technical Specifications	VF1100
Worktable size	1300 x 600 mm
X/Y/Z Travel	1100 / 650 / 600 mm
Rapid feed X / Y / Z	36 m/min
Spindle taper	HSK A63 / BBT40 / BBT50
Spindle speed	18000 / 15000 / 10000 rpm



RIGID MACHINE STRUCTURE

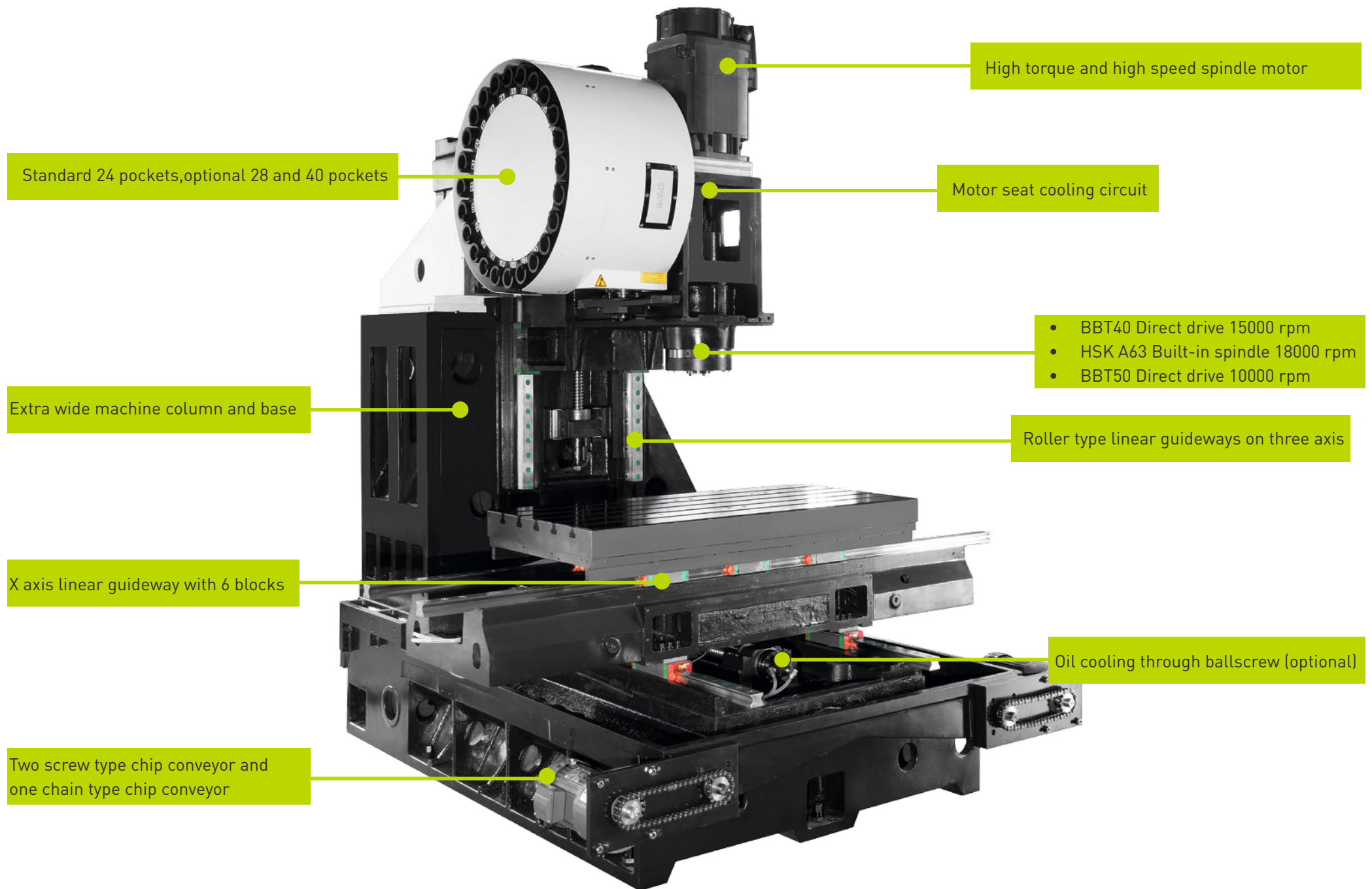

VF760



Technical Specifications	VF 760
Worktable size	900 x 420 mm
X/Y/Z Travel	720 / 450 / 520 mm
Rapid feed X / Y / Z	48 m/min (Opt. 24 m/min)
Spindle taper	HSK A63 / BBT40
Spindle speed	20000 / 12000 rpm

VF 900



Technical Specifications	VF 900
Worktable size	1060 x 600 mm
X/Y/Z Travel	900 / 600 / 600 mm
Rapid feed X / Y / Z	36 m/min
Spindle taper	HSK A63 / BBT40
Spindle speed	20000 / 12000 rpm

VF 1500

Technical Specifications	VF 1500
Worktable size	1700 x 700 mm
X/Y/Z Travel	1500 / 760 / 700 mm
Rapid feed X / Y / Z	24 m/min
Spindle taper	BBT40 / HSK A63 / BBT50
Spindle speed	15000 / 18000 / 10000 rpm





Swiss Rotary Table Technology



High speed

- ✓ Up to 210 rpm
- ✓ up to 0.21 sec / 90°

More space

- ✓ Extended travel in Z- and X-direction

Heavy duty

- ✓ High spindle load, heavy-duty bearing

High torque

- ✓ Feed torque up to 850 Nm

Adaptability

- ✓ Multifunctional spindle HSK

Precision

- ✓ On the workpiece, as precise as 2µm / 100 mm

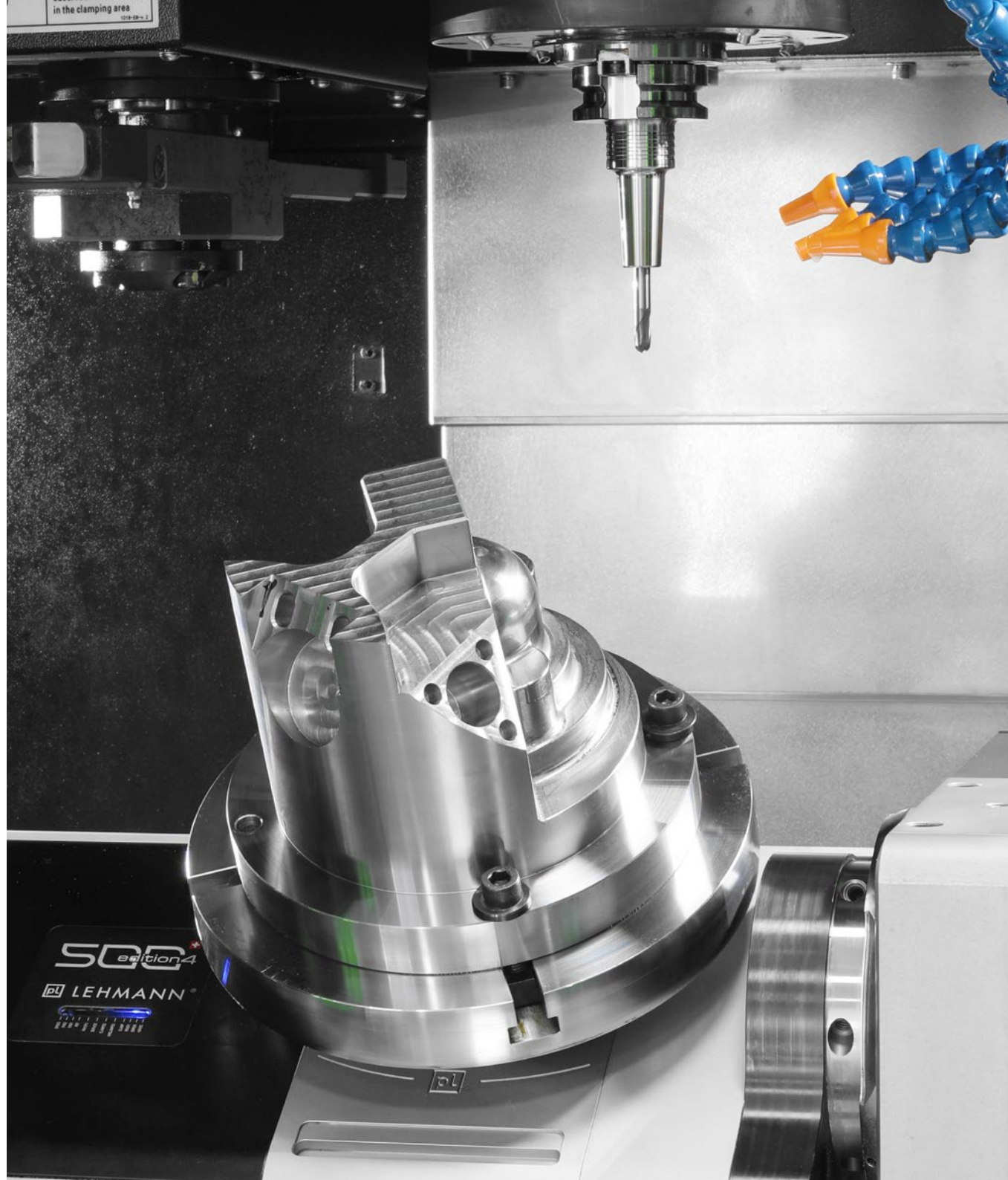

HEIDENHAIN TNC 620 / 640

The TNC contouring control for milling and milling-turning machines

Key features:

Intelligent-Dynamic Precision Machining

- ✓ Dynamic Collision Monitoring (DCM)
- ✓ Dynamic Efficiency
- ✓ Active Chatter Control (ACC)
- ✓ Adaptive feed control (AFC)
- ✓ Machine any contour slot with trochoidal milling

Fast and reliable machining at high contour fidelity

- ✓ Optimal tool guidance by the TNC 640

Programming, Editing, Testing and Automated machining

- ✓ A full range of possibilities with the TNC 640
- ✓ Graphical support in any scenario
- ✓ Straightforward function keys for complex contours
- ✓ Programming free contours and Data Matrix codes
- ✓ Easy calibration of rotary axes with KinematicsOpt

Tool measurement and Workpiece measurement

- ✓ Measuring length, radius, and wear inside the machine
- ✓ Setup, preset setting, and measuring with touch trigger probes
- ✓ Machining and measuring 3-D contours
- ✓ The TNC 640 makes setup easy

Open to outside information

- ✓ Processing CAD files with the TNC 640
- ✓ The TNC 640 programming station
- ✓ Uniformly digital job management with Connected Machining
- ✓ Machining and measuring 3-D contours
- ✓ The TNC 640 makes setup easy



SIEMENS SINUMERIK 828D

The perfect solution for all performance classes

New Panel Processing Unit

- ✓ Higher processor performance
- ✓ Digital Input with higher voltage stability
- ✓ 1GB Ethernet interface X130
- ✓ Pull-relief for the DRIVE-CLiQ and PN cables
- ✓ More robust touch-operation 15,6" PPU290.4

Features for milling Cogging torque compensation and 2nd channel for milling

- ✓ System integrated function
 - Drive-based function SINAMICS
- ✓ Automatic measure of the cogging torque
- ✓ Pre-control of periodic repetitive torque ripple
- ✓ Function available for rotative-, linear- and torque motors
- ✓ 2nd Channel Milling
 - For both machining and handling & robot purpose

Nodding Compensation ECO/Advanced and Advanced Position Control ECO

- ✓ Intelligent control based compensation
 - New developed compensation algorithm
- ✓ System integrated function
 - As a CNC and HMI feature
- ✓ Scalable function in 3 steps
 - ECO
 - Advanced
 - Compile Cycle
- ✓ Commissioning support with HMI masks
 - Additional input mask from SINUMERIK Operate

Higher speed, more accurate for the entry level

Tool Ident Connection

Jerk Adaption

Top Speed plus

Intelligent Load Control (ILC)

Intelligent Dynamic Control (IDC)



TECHNICAL SPECIFICATIONS

Technical Specifications	VF760	VF900	VF1100	VF1300	VF1500
Table					
Table size	900 x 420 mm	1060 x 600 mm	1300 x 600 mm	1500 x 650 mm	1700 x 700 mm
T-slot (width x number x distance)	14 x 3 x 125 mm		18 x 5 x 100 mm		18 x 6 x 100 mm
Max. load	500 kg	800 kg	1000 kg	1200 kg	1500 kg
Travel					
X/Y/Z Travel	720/450/520 mm	900/600/600 mm	1100/650/600 mm	1300/650/600 mm	1500/760/700 mm
Spindle nose to table	100 - 620 mm		150 - 750 mm		130 - 830 mm
Spindle center to column	517 mm	652 mm		697 mm	802 mm
Spindle					
Spindle (standard)	SK40/BBT40/CAT 40				
Spindle speed	12000 rpm		15000 rpm(SIEMENS), 12000 rpm (FANUC)		
Motor power/torque	9/22kW; 63/135Nm (SIEMENS) 11/18.5kW; 52.5/118Nm (FANUC)		20/53kW; 126/250Nm (SIEMENS) 15/30kW; 95.5/191Nm (FANUC)		
Spindle (option 1)	HSK A63, 20000rpm (SIEMENS)		HSK A63, 18000rpm (SIEMENS)		
Motor power/torque	20/24kW; 48/58Nm		30/36kW; 85/102Nm		
Spindle (option 2)	/		BBT50, 10000 rpm (SIEMENS)		
Motor power/torque	/		20/53 kW; 126/250Nm		
Feed					
Rapid feed X/Y/Z	48 m/min (24 opt.)		36 m/min		24 m/min
Cutting feed			1 - 12000 mm/min		
Tool changer					
Number of tools			24 pcs		
Max. tool length			300 mm		
Max. tool diameter			Φ78/Φ125 mm		
Max. tool weight			8 kg		
Accuracy (VDI 3441 Full travel)					
Positioning accuracy (without linear scales)		0.008 mm			0.010 mm
Positioning repeatability (without linear scales)		0.006 mm			0.006 mm
Positioning accuracy (with linear scales)		0.006 mm			0.008 mm
Positioning repeatability (with linear scales)		0.004 mm			0.006 mm
Dimensions & Weight					
Dimensions	3250×2710×2900 mm	3850×2340×3000 mm	3850×3100×3185 mm	4025×3090×3185 mm	5180×2365×3170 mm
Weight	4500 kg	6500 kg	7500 kg	8000 kg	10000 kg

TORQUE DIAGRAM

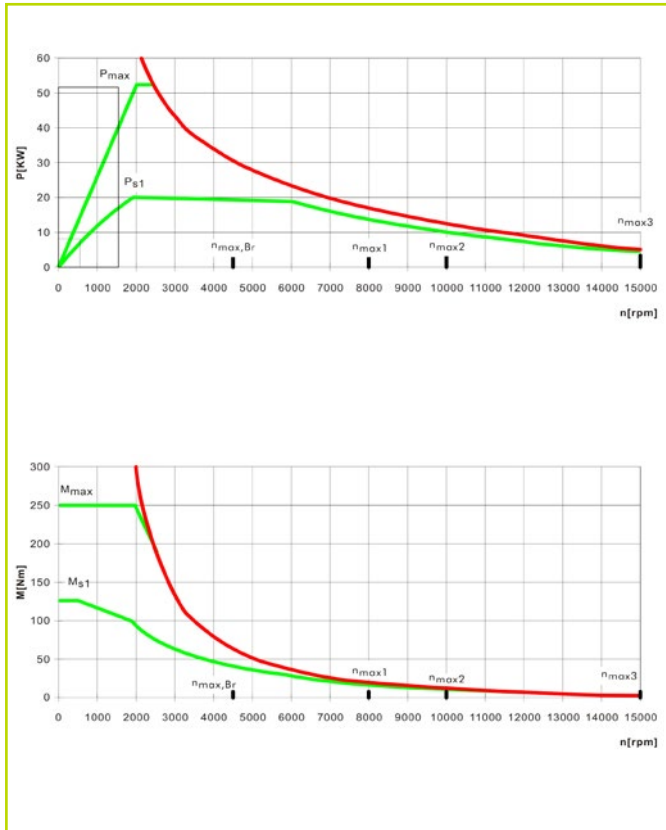

BBT40 - 15000 rpm
20/53kW 126/250Nm

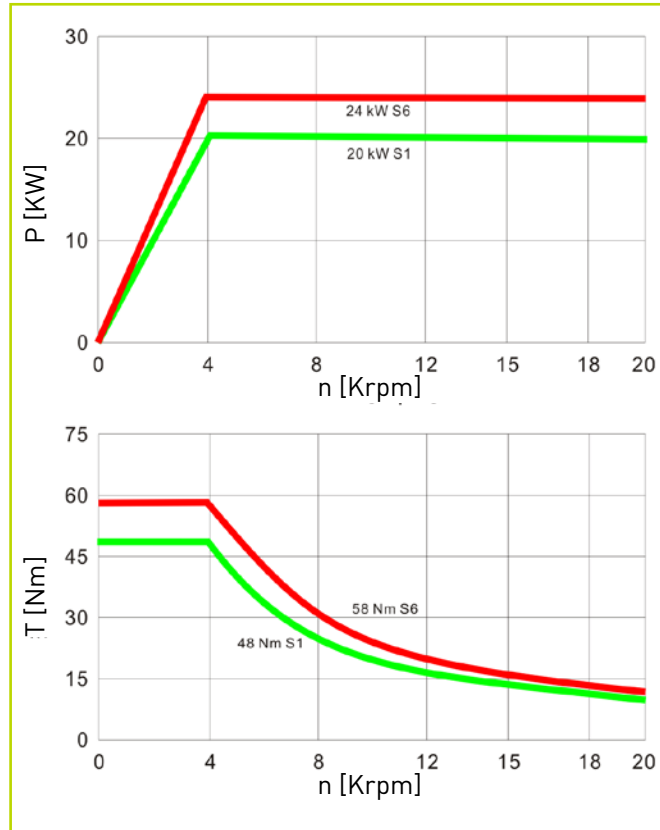

HSK A63 - 20000 rpm
20/24kW 48/58Nm

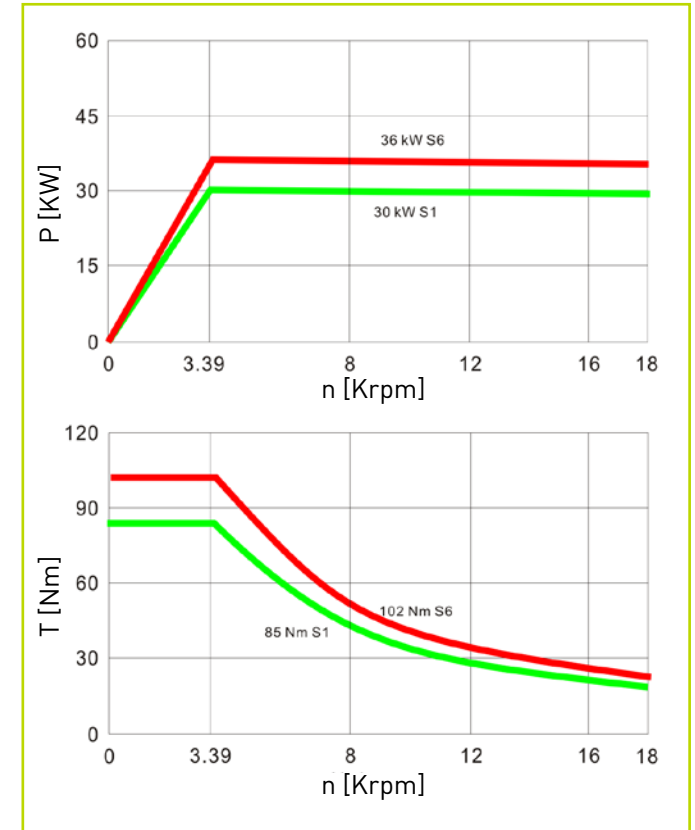

HSK A63 - 18000 rpm
30/36kW 85/102Nm

DIMENSIONS OF VF760

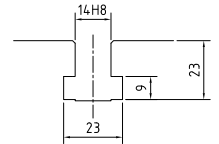
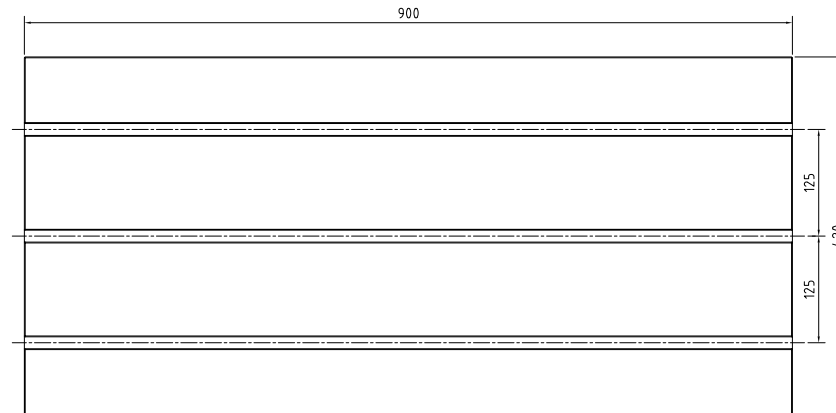
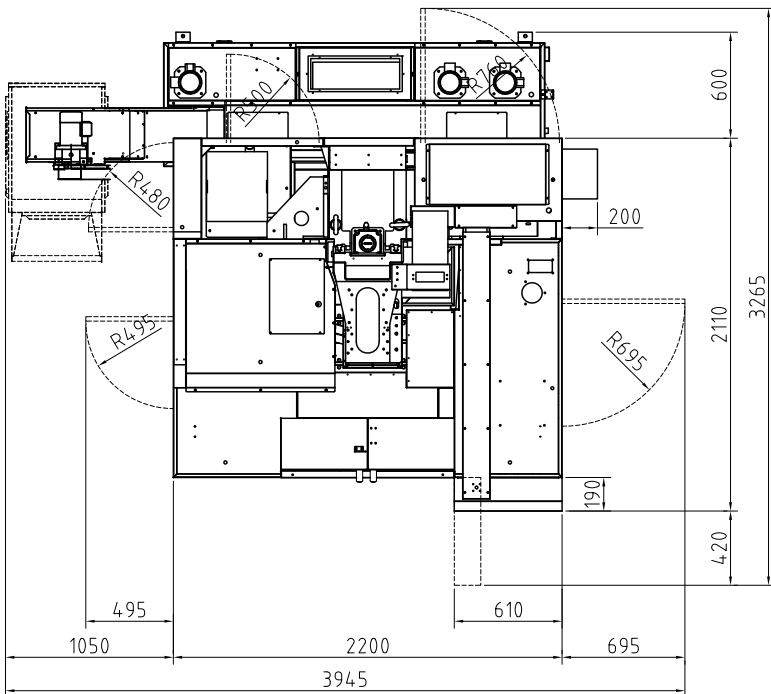
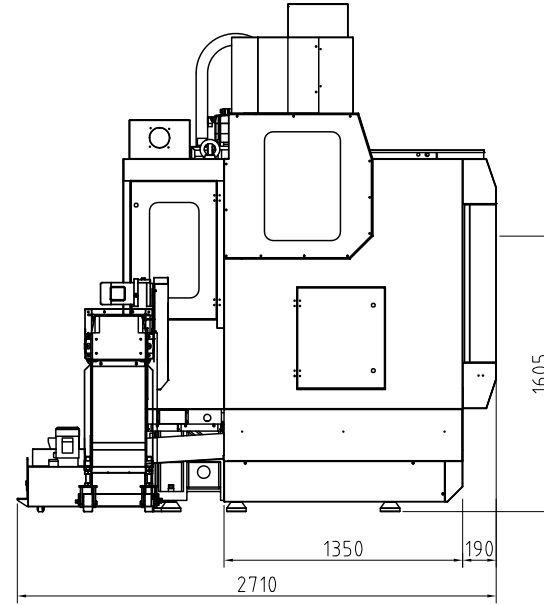
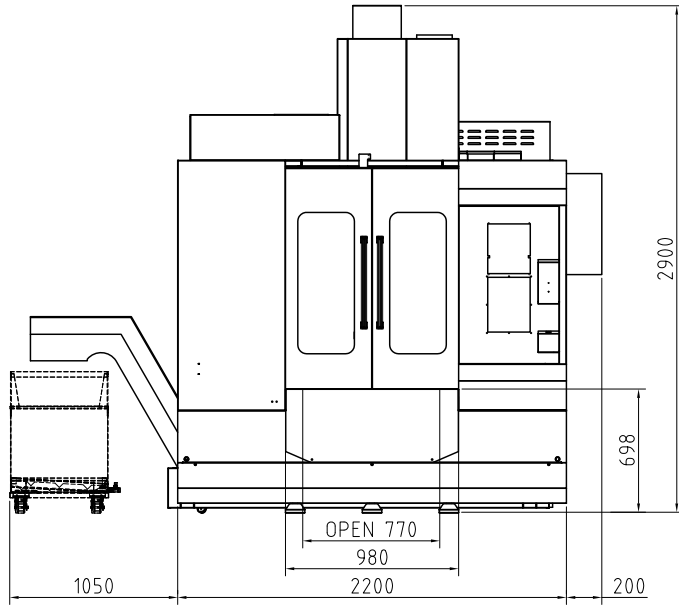

DIMENSIONS OF VF900

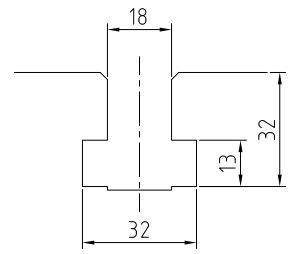
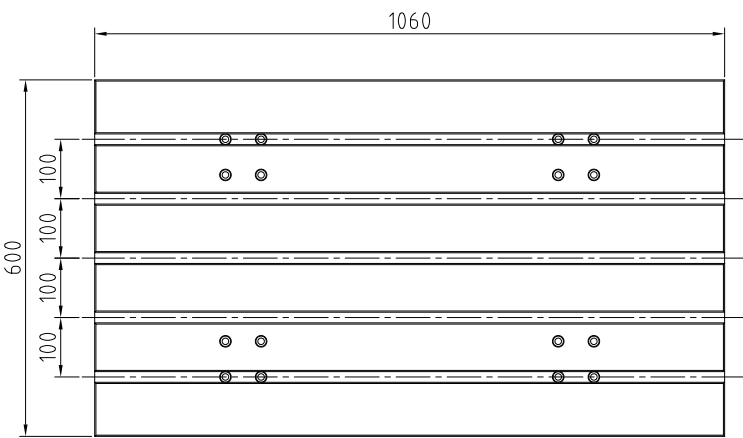
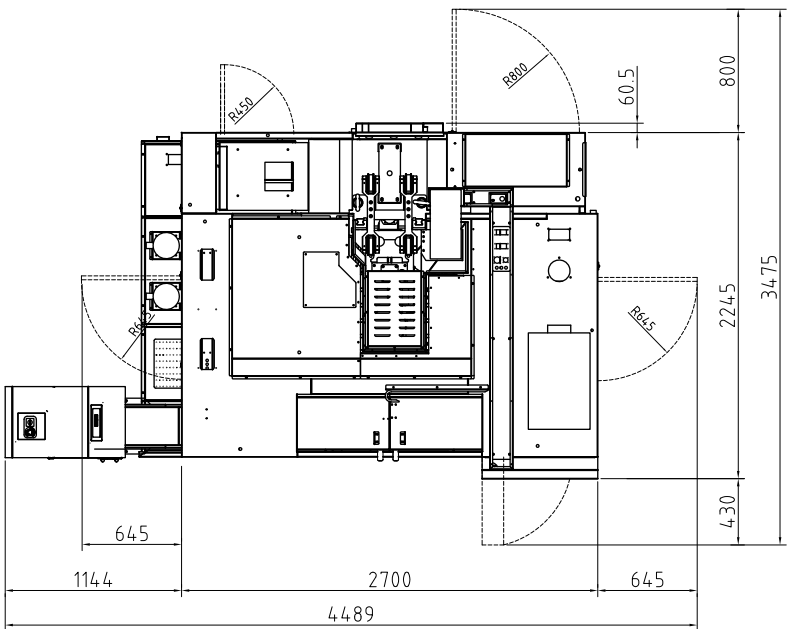
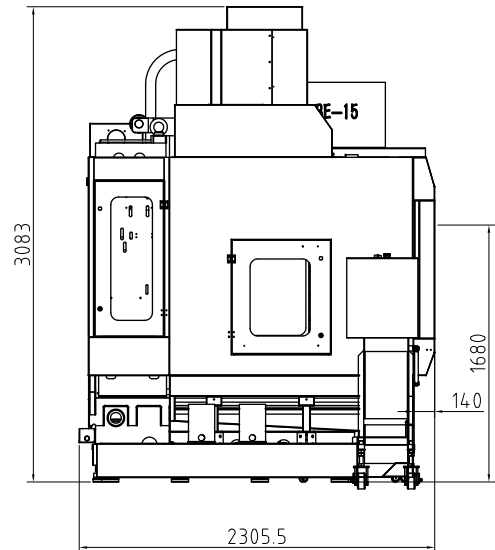
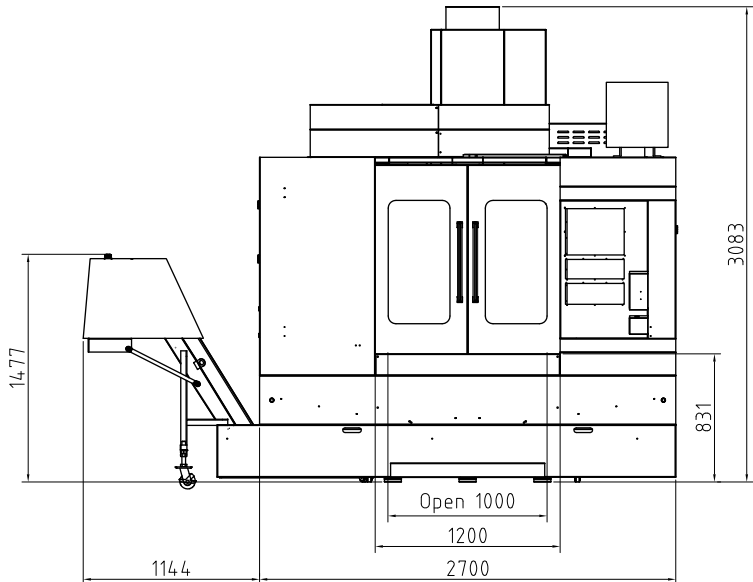

DIMENSIONS OF VF1100

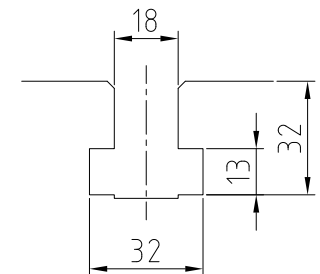
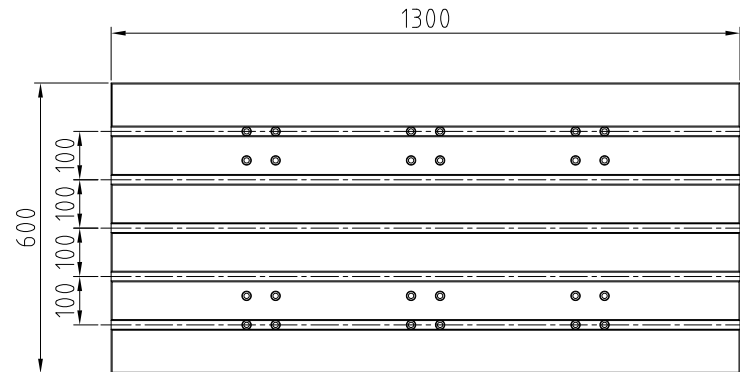
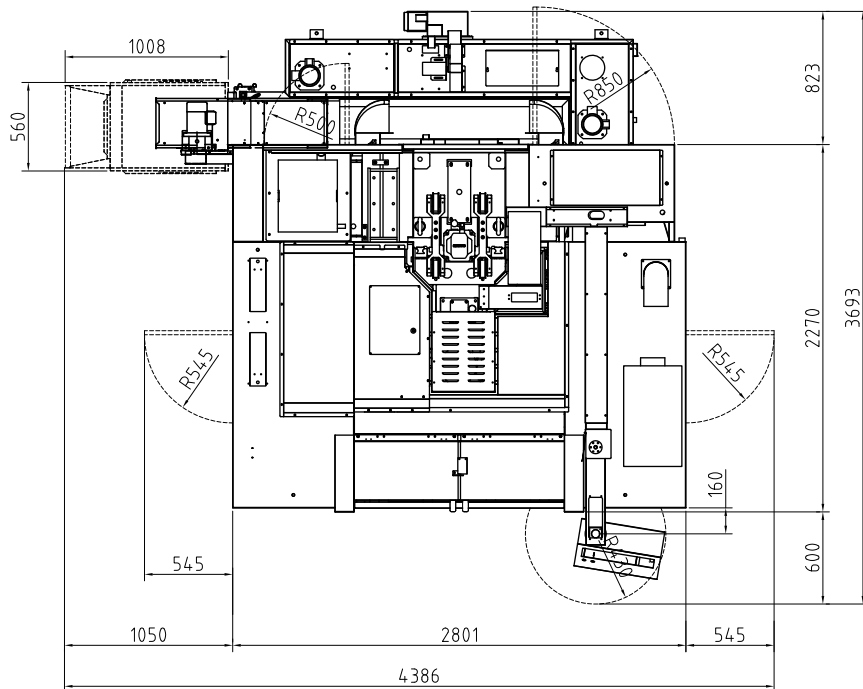
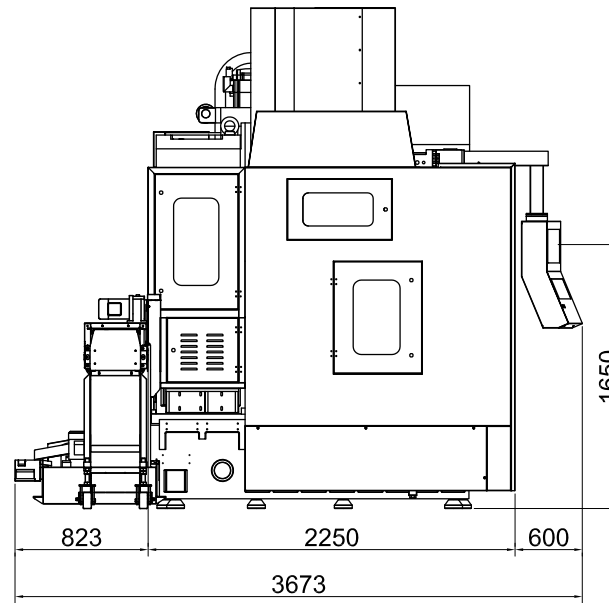
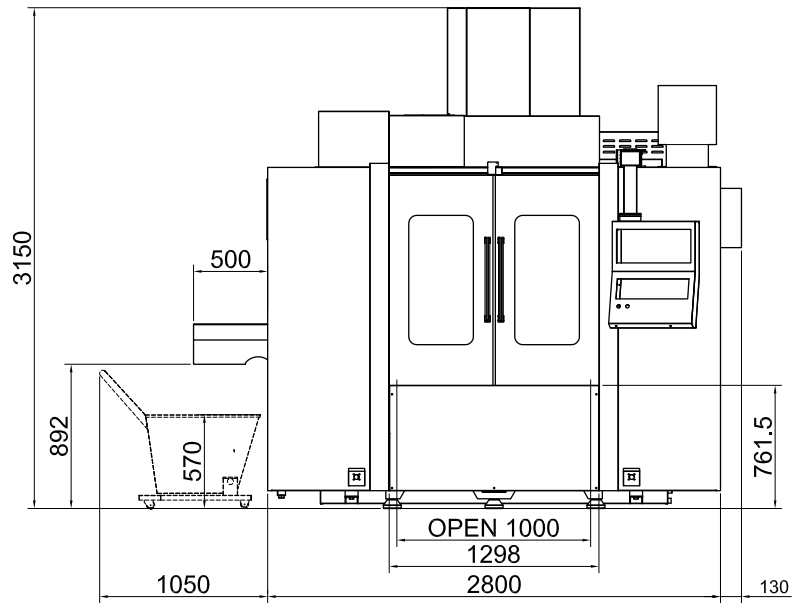

DIMENSIONS OF VF1500

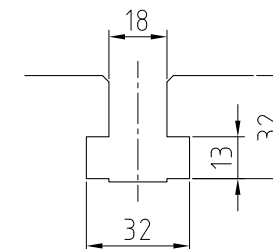
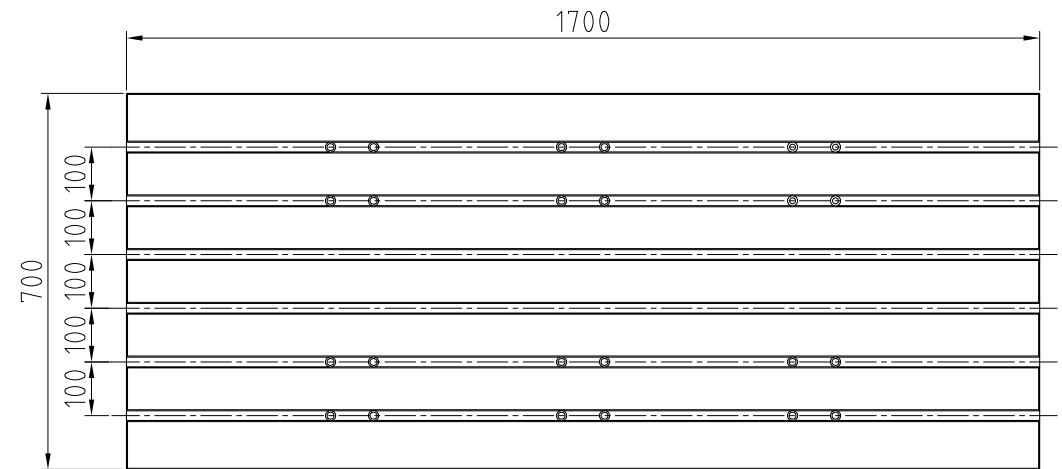
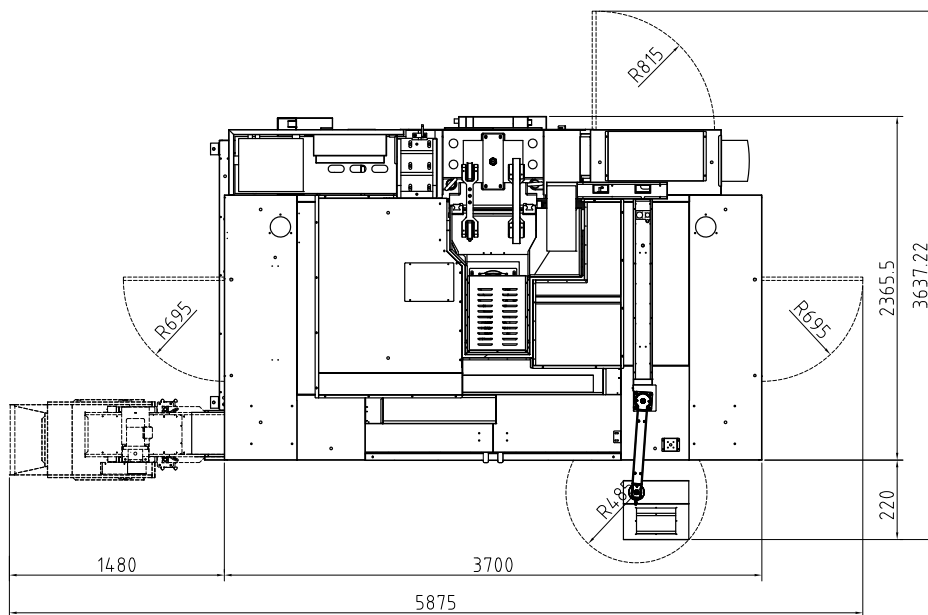
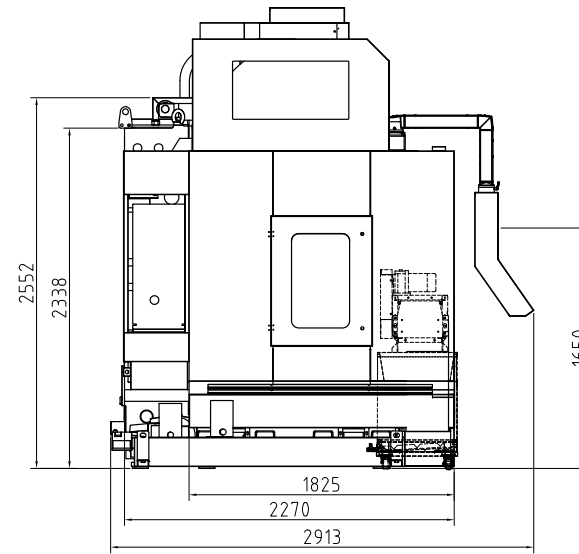
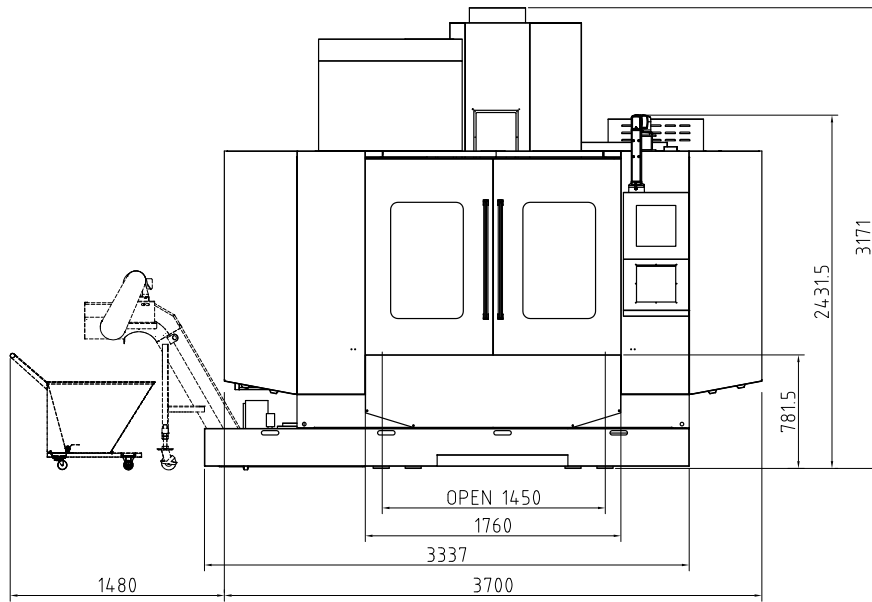

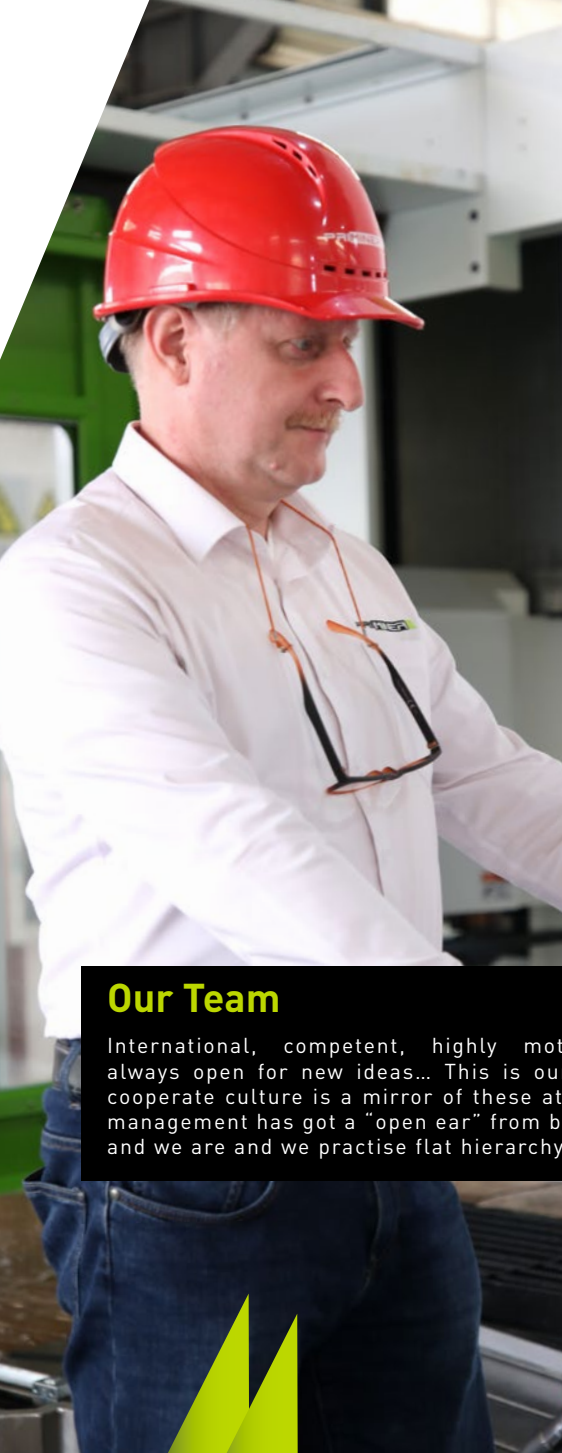

Our Team

International, competent, highly motivated and always open for new ideas... This is our team. The cooperate culture is a mirror of these attitudes. Our management has got a "open ear" from bottom to top and we are and we practise flat hierarchy.

PRIMINER Global TEAM



PRIMINER Solutions



hyperMILL

SolidCAM
The Leaders in Integrated CAM



DIJET NS TOOL

GÜHRING



PL LEHMANN



SCHUNK



HAIMER



Blaser.
SWISSLUBE



REGO-FIX



BLUM
focus on productivity

WORKPIECE SAMPLES

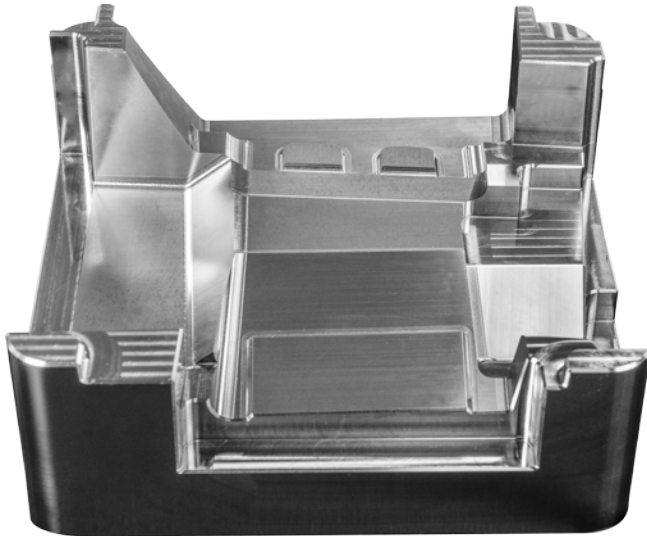
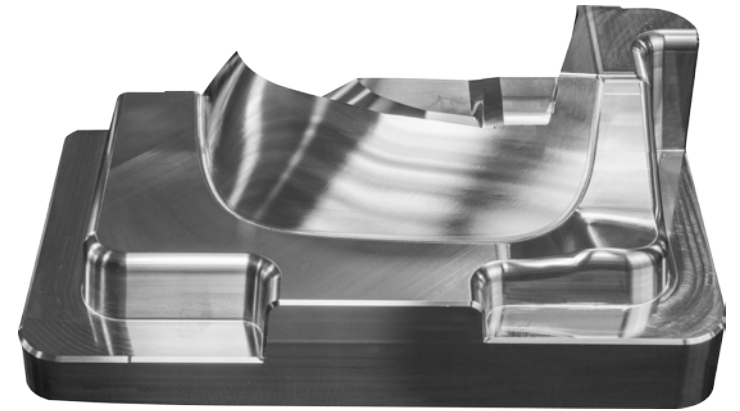
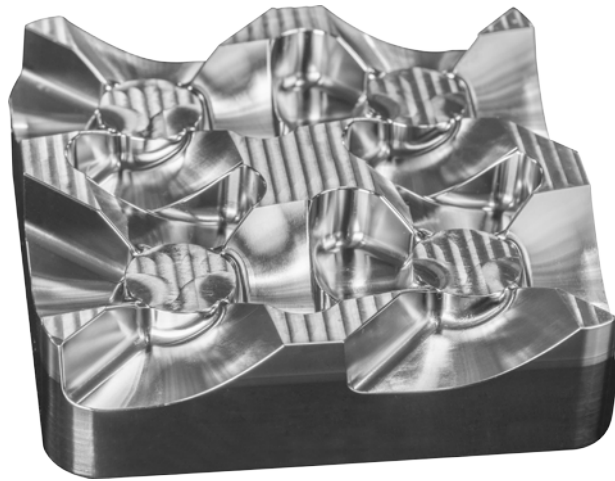

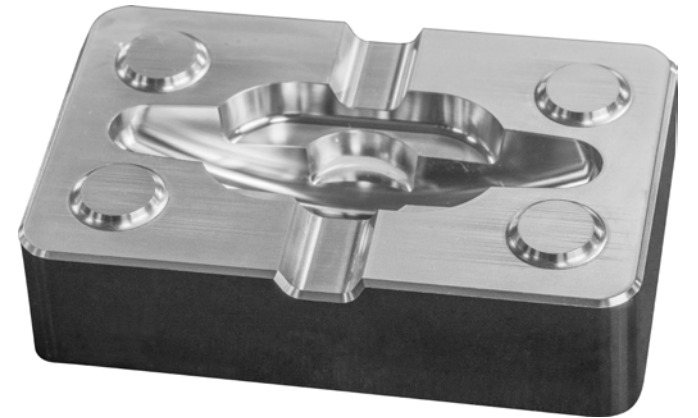
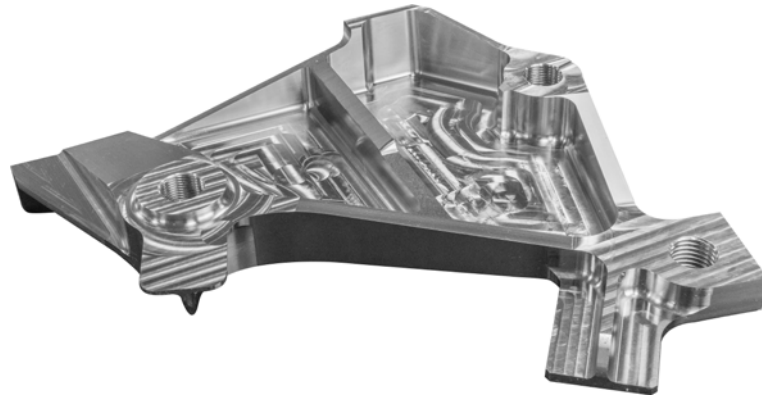
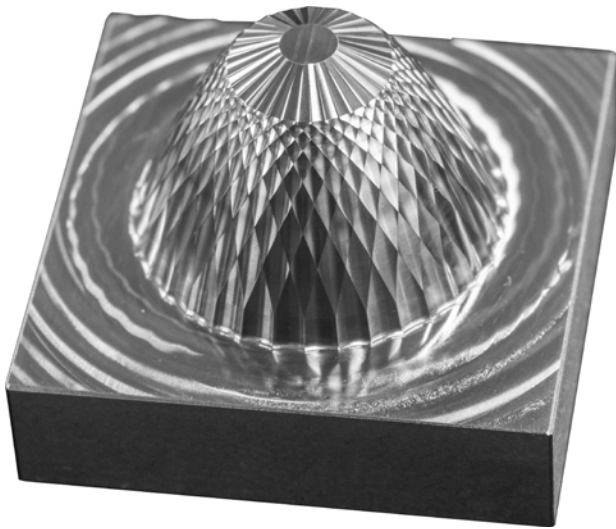
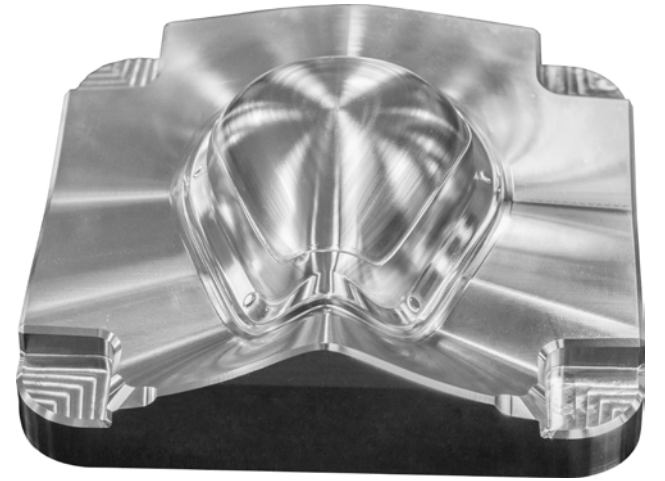
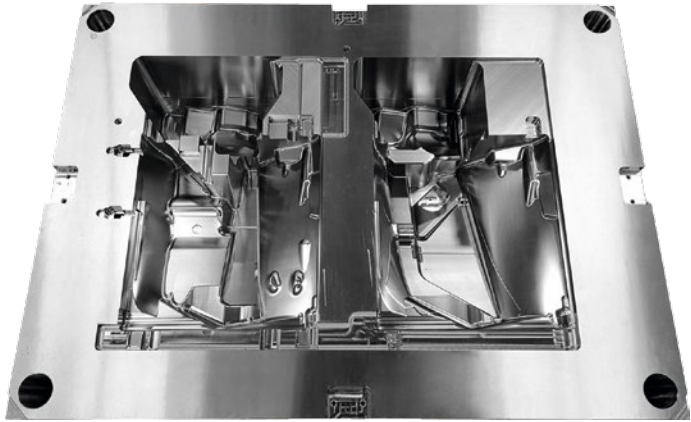

PRIMINER

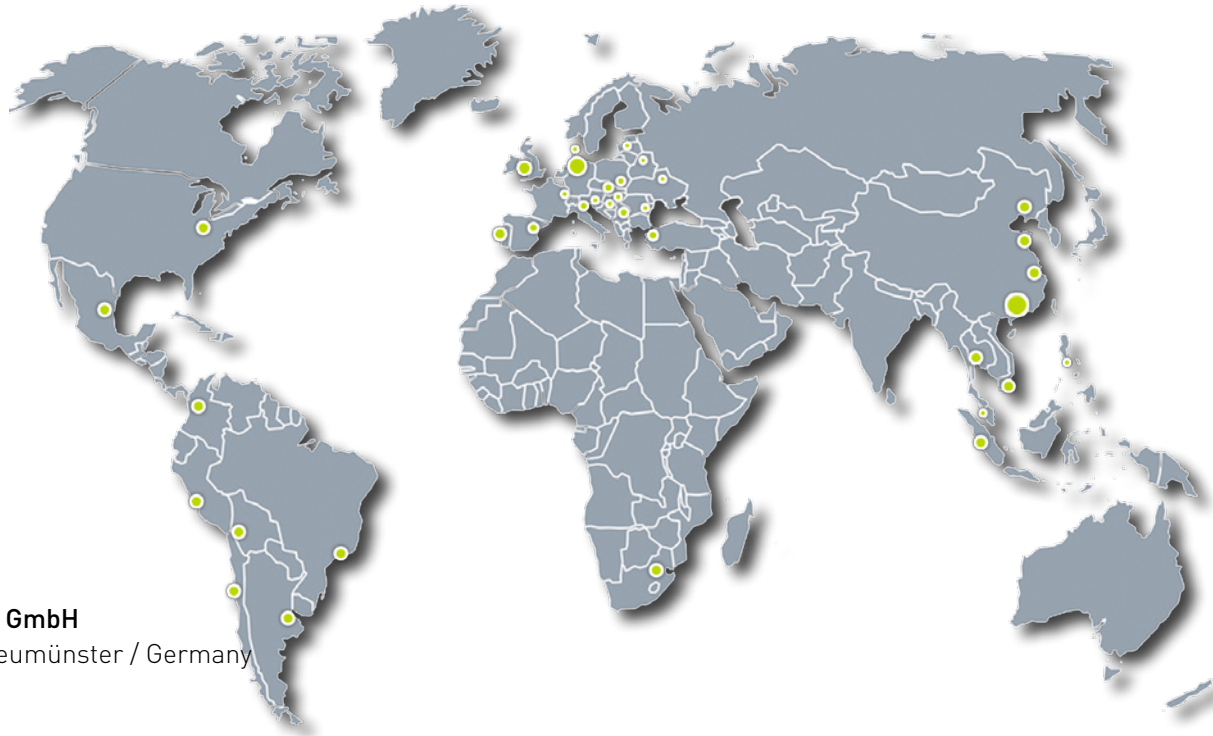

PRIMINER Werkzeugmaschinen GmbH

Tungendorfer Str.10 · D-24536 Neumünster / Germany
Tel: +49 (0) 4321-53 9946 -0
Fax: +49 (0) 4321-25 2003 -90
E-mail: info@priminer.de

PRIMINER SOUTH EAST EUROPE · PRIMINER d.o.o. BEOGRAD

Vladimira Popovica 38-40 · GTC - 11070 Beograd / Srbija
Tel: +381 69 702 705
Fax: +381 11 715 69 00
E-mail: office@priminer.de

PRIMINER MACHINE TOOLS DONGGUAN CO., LTD

XinRuYi Industrial Park, Fuxing Road, Xingguang Village, Huangjiang Town, Dongguan, P.R.China
Tel: +86 769 838 490 61
Fax: +86 769 838 490 62
E-mail: sales@priminer.de

www.priminer.de